

Crane

CLOCK RADIO WITH DUAL ALARM

MODEL: MMG-CR1210

BEFORE OPERATING THIS PRODUCT, PLEASE READ THESE INSTRUCTIONS COMPLETELY.



OPERATING INSTRUCTIONS

SAFETY PRECAUTIONS



CAUTION
RISK OF ELECTRIC SHOCK
DO NOT OPEN



CAUTION: TO REDUCE THE RISK OF ELECTRIC SHOCK, DO NOT REMOVE COVER (OR BACK). NO USER-SERVICEABLE PARTS INSIDE. REFER SERVICING TO QUALIFIED SERVICE PERSONNEL.



DANGEROUS VOLTAGE:
Uninsulated Dangerous Voltage, that may be of sufficient magnitude to constitute a risk of electric shock to persons is present within this product's enclosure.



ATTENTION:
The Owner's Manual contains important operating and maintenance instructions.
For your safety, it is necessary to refer to the manual.

FCC WARNING:

This equipment may generate or use radio frequency energy. Changes or modifications to this equipment may cause harmful interference unless the modifications are expressly approved in the instruction manual. The user could lose the authority to operate this equipment if an unauthorized change or modification is made.

PLEASE KEEP ALL PACKAGING MATERIAL FOR AT LEAST 90 DAYS IN CASE YOU NEED TO RETURN THIS PRODUCT TO YOUR PLACE OF PURCHASE OR MEMOREX.

INFORMATION:

This equipment has been tested and found to comply with the limits for a Class B digital device, pursuant to Part 15 of the FCC Rules. These limits are designed to provide reasonable protection against harmful interference in a residential installation. This equipment generates, uses, and can radiate radio frequency energy and, if not installed and used in accordance with instructions, may cause harmful interference to radio communications. However, there is no guarantee that interference will not occur in a particular installation. If this equipment does cause harmful interference to radio or television reception, which can be determined by turning the equipment off and on, the user is encouraged to try to correct the interference by one or more of the following measures:

- Reorient or relocate the receiving antenna.
- Increase the separation between the equipment and receiver.
- Connect the equipment into an outlet on a circuit different from that to which the receiver is connected.
- Consult the dealer or an experienced radio/TV technician for help.

IMPORTANT SAFETY INSTRUCTIONS

Before using the unit, be sure to read all operating instructions carefully. Please note that these are general precautions and may not pertain to your unit. For example, this unit may not have the capability to be connected to an outdoor antenna.

1. READ INSTRUCTIONS

All the safety and operating instructions should be read before the product is operated.

2. RETAIN INSTRUCTIONS

The safety and operating instructions should be retained for future reference.

3. HEED WARNINGS

All warnings on the product and in the operating instructions should be adhered to.

4. FOLLOW INSTRUCTIONS

All operating and use instructions should be followed.

5. CLEANING

Unplug this product from the wall outlet before cleaning. Do not use liquid cleaners or aerosol cleaners. Use a damp cloth for cleaning.

6. ATTACHMENTS

Do not use attachments not recommended by the product's manufacturer as they may cause hazards.

7. WATER AND MOISTURE

Do not use this product near water- for example, near a bathtub, washbowl, kitchen sink, or laundry tub, in a wet basement, or near a swimming pool.

8. ACCESSORIES

Do not place this product on an unstable cart, stand, tripod, bracket, or table. The product may fall, causing serious injury and serious damage to the product. Use only with a cart, stand, tripod, bracket, or table recommended by the manufacturer or sold with the product. Any mounting of the product should follow the manufacturer's instructions, and should use a mounting accessory recommended by the manufacturer.

- 8A.** An appliance and cart combination should be moved with care. Quick stops, excessive force, and uneven surfaces may cause the appliance and cart combination to overturn.



9. VENTILATION

Slots and openings in the cabinet and in the back or bottom are provided for ventilation and to ensure reliable operation of the product and to protect it from overheating. These openings must not be blocked or covered. The openings should never be blocked by placing the product on a bed, sofa, rug, or other similar surface. This product should never be placed near or over a radiator or heat source. This product should not be placed in a built-in installation such as a bookcase or rack unless proper ventilation is provided or the manufacturer's instructions have been adhered to.

10. POWER SOURCES

This product should be operated only from the

IMPORTANT SAFETY INSTRUCTIONS (CONTINUED)

type of power source indicated on the marking label. If you are not sure of the type of power supply to your home, consult your appliance dealer or local power company. For products intended to operate from battery power, or other sources, refer to the operating instructions.

- 11. GROUNDING OR POLARIZATION**
This product is equipped with a polarized alternating-current line plug (a plug having one blade wider than the other). This plug will fit into the power outlet only one way. This is a safety feature. If you are unable to insert the plug fully into the outlet, try reversing the plug. If the plug should still fail to fit, contact your electrician to replace your obsolete outlet. Do not defeat the safety purpose of the polarized plug.
- 12. POWER-CORD PROTECTION**
Power-supply cords should be routed so that they are not likely to be walked on or pinched by items placed upon or against them, paying particular attention to cords at plugs, convenience receptacles, and the point where they exit from the appliance.
- 13. LIGHTNING**
To protect your product from a lightning storm, or when it is left unattended and unused for long periods of time, unplug it from the wall outlet and disconnect the antenna or cable system. This will prevent damage to the product due to lightning and power-line surges.
- 14. POWER LINES**
An outside antenna system should not be located in the vicinity of overhead power lines or other electric light or power circuits, or where it can fall into such power lines or circuits. When installing an outside antenna system, extreme care should be taken to keep from touching such power lines or circuits as contact with them might be fatal.
- 15. OVERLOADING**
Do not overload wall outlets and extension cords as this can result in a risk of fire or electric shock.
- 16. OBJECT AND LIQUID ENTRY**
Never push objects of any kind into this product through openings as they may touch dangerous voltage points or short out parts that could result in fire or electric shock. Never spill or spray any type of liquid on the product.
- 17. SERVICING**
Do not attempt to service this product yourself as opening or removing covers may expose you to dangerous voltage or other hazards. Refer all servicing to qualified service personnel.
- 18. REPLACEMENT PARTS**
When replacement parts are required, be sure the service technician uses replacement parts specified by the manufacturer or those that have the same characteristics as the original part. Unauthorized substitutions may result in fire, electric shock or other hazards.
- 19. SAFETY CHECK**
Upon completion of any service or repairs to this product, ask the service technician to perform safety checks to determine that the product is in proper operating condition.
- 20. WALL OR CEILING MOUNTING**
The product should be mounted to a wall or ceiling only as recommended by the manufacturer.
- 21. DAMAGE REQUIRING SERVICE**
Unplug the product from the wall outlet and refer servicing to qualified service personnel under the following conditions:
 - a. When the power-supply cord or plug is damaged.
 - b. If liquid has been spilled, or objects have fallen into the product.
 - c. If the product has been exposed to rain or water.
 - d. If the product does not operate normally by following the operating instructions. Adjust only those controls that are covered by the operating instructions, as an adjustment of other controls may result in damage and will often require extensive work by a qualified technician to restore the product to its normal operation.
 - e. If the product has been dropped or the cabinet has been damaged.
 - f. When the product exhibits a distinct change in performance - this indicates a need for service.
- 22. HEAT**
The product should be situated away from heat sources such as radiators, heat registers, stoves, or other products (including amplifiers) that produce heat.
- 23. NOTE TO CATV SYSTEM INSTALLER**
This reminder is provided to call the CATV system installer's attention to Article 820-40 of the NEC that provides guidelines for proper grounding and, in particular, specifies that the cable ground shall be connected to the grounding system of the building, as close to the point of cable entry as practical.
- 24. NONUSE PERIODS**
The power cord of the appliance should be unplugged from the outlet when left unused for a long period of time.

Dear Customer:

Selecting fine audio equipment such as the unit you've just purchased is only the start of your musical enjoyment. Now it's time to consider how you can maximize the fun and excitement your equipment offers. This manufacturer and the Electronic Industries Association's Consumer Electronics Group want you to get the most out of your equipment by playing it at a safe level. One that lets the sound come through loud and clear without annoying blaring or distortion and, most importantly, without affecting your sensitive hearing. Sound can be deceiving. Over time your hearing "comfort level" adapts to higher volumes of sound. So what sounds "normal" can actually be loud and harmful to your hearing. Guard against this by setting your equipment at a safe level BEFORE your hearing adapts.

To establish a safe level:

- Start your volume control at a low setting.
- Slowly increase the sound until you can hear it comfortably and clearly, and without distortion.

Once you have established a comfortable sound level:

- Set the dial and leave it there.

Taking a minute to do this now will help to prevent hearing damage or loss in the future. After all, we want you listening for a lifetime.

We Want You Listening For A Lifetime

Used wisely, your new sound equipment will provide a lifetime of fun and enjoyment. Since hearing damage from loud noise is often undetectable until it is too late, this manufacturer and the Electronic Industries Association's Consumer Electronics Group recommend you avoid prolonged exposure to excessive noise. This list of sound levels is included for your protection.

Decibel Level

Level	Example
30	Quiet library, soft whispers
40	Living room, refrigerator, bedroom away from traffic
50	Light traffic, normal conversation, quiet office
60	Air conditioner at 20 feet, sewing machine
70	Vacuum cleaner, hair dryer, noisy restaurant
80	Average city traffic, garbage disposals, alarm clock at two feet

THE FOLLOWING NOISES CAN BE DANGEROUS UNDER CONSTANT EXPOSURE:

90	Subway, motorcycle, truck traffic, lawn mower
100	Garbage truck, chain saw, pneumatic drill
120	Rock band concert in front of speakers, thunderclap
140	Gunshot blast, jet engine
180	Rocket launching pad

Information courtesy of the Deafness Research Foundation.



LOCATION OF CONTROLS

FRONT

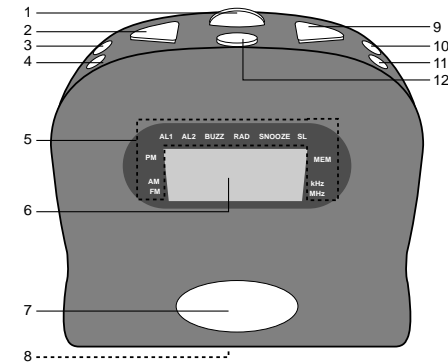

1. VOLUME Control
2. REV (Reverse) Button
3. BAND Button
4. MODE Button
5. Indicators
6. Display
7. SNOOZE Button
8. Battery/FM Antenna Wire Compartment (Bottom of Unit)
9. FWD (Forward) Button
10. PRESET Button
11. MEMORY Button
12. ON/OFF Button
13. ALARM 1 ON/OFF Button
14. ALARM 2 ON/OFF Button
15. AC Cord
16. DIMMER Button
17. SLEEP Button
18. RADIO/BUZZ Button

REAR

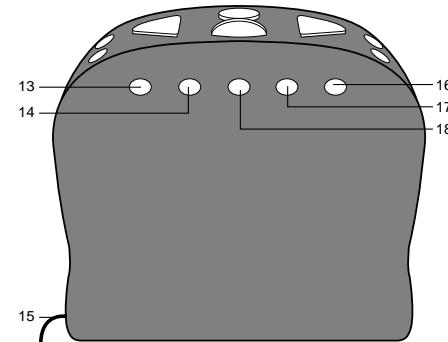

INSTALLATION

Unravel the AC cord and connect it to a conveniently located AC outlet having 120V and 60Hz only. The Clock Display will illuminate and "12:00" will blink in the window.

NOTE: If the AC plug does not fit into a nonpolarized outlet, do not file or cut the wide blade. If the AC plug does not fit into a nonpolarized AC outlet, do not file or cut the wide blade. It is the user's responsibility to have an electrician replace the obsolete outlet.

If the AC cord is disconnected or if there is a power failure, this electronic clock is designed to continue operating internally (without showing the time on the Clock Display) with two (2) AA size batteries (not included).

To install the batteries:

- Remove the battery compartment door by sliding it out.
- Insert two (2) AA size batteries into the battery compartment to the right. Be sure to observe the polarity markings which are engraved inside the battery compartment. If the batteries are inserted incorrectly, the unit will not operate.
- Replace the battery compartment door.

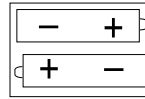
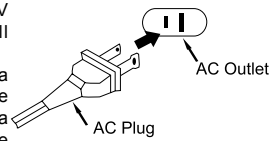

Be sure to check the condition of the batteries periodically by disconnecting the AC cord and connecting it again two or three minutes later. The preset times should continue operating. If the present time does not appear, it indicates the battery is dead or not connected properly.

BATTERY PRECAUTIONS

Follow these precautions when using batteries in this device:

1. Use only the size and type of batteries specified.
2. Be sure to follow the correct polarity when installing the batteries as indicated in the battery compartment. Reversed batteries may cause damage to the device.
3. Do not mix different types of batteries together (e.g. Alkaline and Carbon-zinc) or old batteries with fresh ones.
4. If the device is not to be used for a long period of time, remove the batteries to prevent damage or injury from possible battery leakage.
5. Do not try to recharge batteries not intended to be recharged; they can overheat and rupture. (Follow battery manufacturer's directions.)

OPERATION

TO LISTEN TO THE RADIO

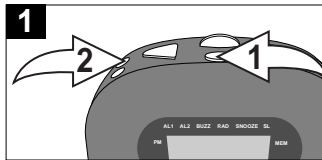

Press the ON/OFF button ❶ to turn the unit on; the AM or FM indicator will light. Press the BAND button ❷ to select AM or FM.

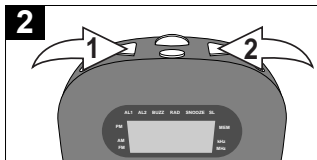

Tune a station by pressing the REV ❶ or FWD ❷ button. Press and hold the REV ❶ or FWD ❷ button and the unit will scan and stop on the next strong station.

Antennas

FM: Extend the FM antenna wire (located in the battery compartment) for best reception.

AM: Turn the unit for better AM reception.

SETTING RADIO PRESETS

(10 PRESETS FOR AM, 10 FOR FM)

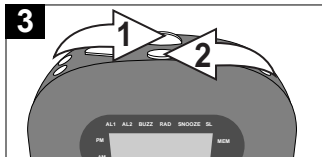

Adjust the volume using the VOLUME control ❶. Press the ON/OFF button ❷ to turn the unit off.

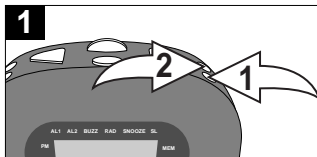

Tune a station as described in step 1 above, then press the MEMORY button ❶ once; the MEM indicator will blink. Press the PRESET button ❷ to select a radio preset number, then press the MEMORY button ❶ again to confirm and the radio preset will be set.

OPERATION (CONTINUED)

TO RECALL RADIO PRESETS

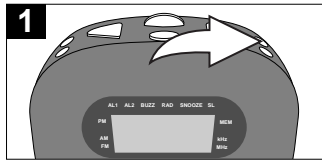

To recall a Radio Preset, press the PRESET button repeatedly until the desired Radio Preset appears in the display.

TO CHANGE A RADIO PRESET

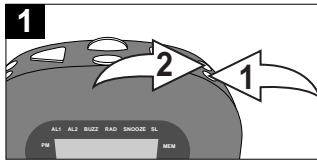

To change a Radio Preset, simply tune a radio station as described on the previous page, then press the MEMORY button ❶; the MEM indicator will blink. Repeatedly press the PRESET button ❷ until the desired Radio Preset appears in the display, then press the MEMORY button ❶ again to memorize.

NOTE: Once a radio frequency is selected, the display will revert to the time display after 10 seconds.

TO SET OR RESET THE ACTUAL TIME

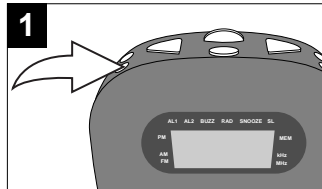

With the unit off, press the MODE button once to set the time and the display will blink.

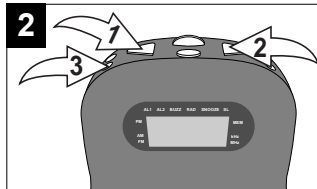

Press the REV ❶ to set the hour and the FWD ❷ button to set the minute. Make sure the PM indicator is lit if you are setting to PM, and make sure it is not lit if setting to AM. Wait 10 seconds, or press the MODE button ❸ three times and the time will be set.

OPERATION (CONTINUED)

TO SET OR RESET THE ALARM TIME(S)

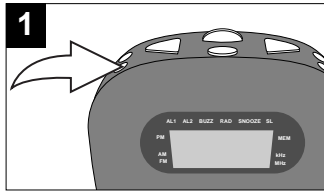

With the unit off, press the MODE button twice to set Alarm 1, or three times to set Alarm 2, "AL1" or "AL2" will appear in the display

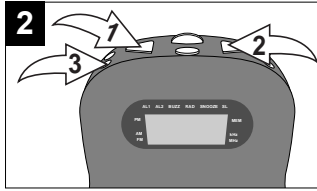

Press the REV 1 to set the alarm hour and the FWD 2 button to set the alarm minute. Make sure the PM indicator is lit if you are setting to PM, and make sure it is not lit if setting to AM. Wait 10 seconds, or press the MODE button 3 until the WAKE indicator disappears from the display to set the Alarm 1 or 2.

TO SET THE ALARM TO WAKE TO RADIO

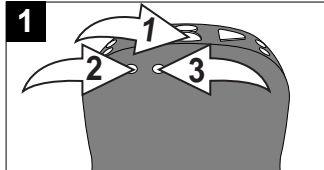

Set the alarm time as previously instructed. Select a radio station as described on page 7 and make sure the VOLUME control 1 is set as desired. Press the desired ALARM 1 ON/OFF 2 or ALARM 2 ON/OFF 3 button until the respective AL indicator lights.

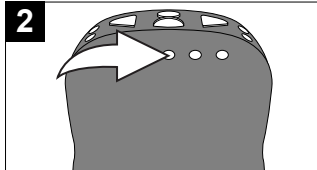

Press the RADIO/BUZZ button until the RAD indicator lights. When the actual time matches the selected preset alarm time, the radio will automatically turn on. To shut off the alarm, see TO SHUT THE ALARM OFF section on the next page.

OPERATION (CONTINUED)

TO SET THE ALARM TO WAKE TO BUZZER

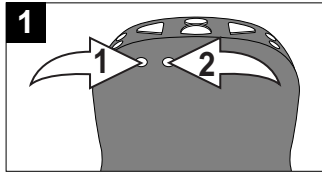

Set the alarm time as previously instructed. Press the desired ALARM 1 ON/OFF ❶ or ALARM 2 ON/OFF ❷ button until the respective AL indicator lights.

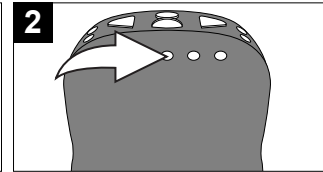

Press the RADIO/BUZZ button until the BUZZ indicator lights. When the actual time matches the selected preset alarm time, the buzzer will automatically sound. To shut off the alarm, see TO SHUT THE ALARM OFF section below.

TO SHUT THE ALARM OFF

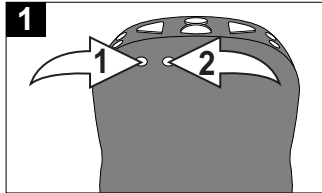

To shut the alarm off, press the ALARM 1 ❶ or 2 ❷ ON/OFF button once to turn off the alarm and not set it for the next day. Press the ALARM 1 ❶ or 2 ❷ ON/OFF button again until the respective AL indicator lights and the alarm time will be reset for the next day.

SNOOZE

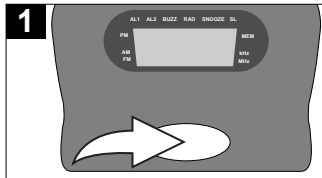

The alarm can be temporarily turned off manually by pressing the SNOOZE button; the alarm will turn back on automatically nine minutes later.

OPERATION (CONTINUED)

TO ACTIVATE THE SLEEP FUNCTION

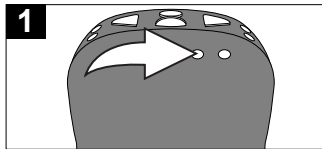

Tune the desired radio station as described on page 7. Press the SLEEP button; the SL indicator will light and "10" will appear on the clock display, then release the button. The unit will turn on for 10 minutes and then turn off.

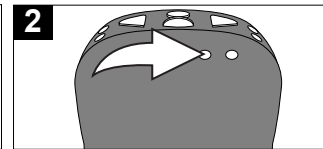

To adjust the sleep time up to 90 minutes in 10 minute intervals, repeatedly press the SLEEP button.

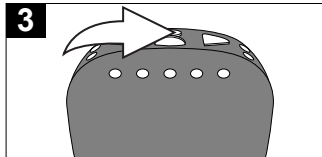

To cancel sleep time, press the ON/OFF button.

DIMMER

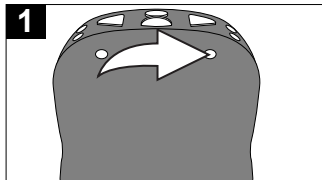

This unit has four levels of brightness for the display. Repeatedly press the DIMMER button until the desired brightness appears in the display.

TROUBLESHOOTING GUIDE

If you experience a problem with this unit, check the chart below before calling for service.

SYMPTOM	POSSIBLE CAUSE	POSSIBLE SOLUTION
GENERAL		
Power does not come on.	AC line cord not plugged in.	Insert plug firmly into AC outlet.
RADIO		
No sound.	ON/OFF button was not pressed.	Press the ON/OFF button to turn the unit on.
	VOLUME control at minimum position.	Increase the VOLUME.
Noise or sound distorted on AM or FM.	AM - Interference from traffic.	Turn the radio for better AM reception.
	FM - Antenna Wire not extended.	Extend Antenna Wire.
CLOCK		
Flashing time.	Batteries connected improperly, not connected or dead.	Check the batteries and replace if necessary.
	Clock not set.	Set the clock.
Alarm does not turn on.	Appropriate ALARM 1 or 2 ON/OFF button is not pressed.	Press the ALARM 1 or 2 button until the respective AL indicator lights.
	Clock is not set.	Set the clock.
	Alarm time not set.	Set alarm time.

SPECIFICATIONS

AUDIO

Frequency Range (AM)530-1720KHz
Frequency Range (FM).....87.5-108MHz

GENERAL

Power SupplyAC 120V, 60Hz (2 AA size batteries for back-up)

FOR ADDITIONAL SET-UP OR OPERATING ASSISTANCE, PLEASE
VISIT OUR WEBSITE AT:

WWW.MEMCORPINC.COM

OR CONTACT CUSTOMER SERVICE AT 1-800-919-3647.

PLEASE KEEP ALL PACKAGING MATERIAL FOR AT LEAST 90
DAYS IN CASE YOU NEED TO RETURN THIS PRODUCT TO YOUR
PLACE OF PURCHASE OR MEMOREX.

FOR PARTS AND ACCESSORIES, CONTACT FOX INT'L AT
1-800-321-6993.

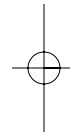
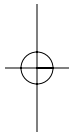

Memcorp, Inc.
Weston, FL
Printed in Hong Kong

Visit our website at www.memcorpinc.com

